



UTS ergo line®

Safety storage cabinets in modern design by



Type 90

Safety storage cabinets
for the highest requirements



Welcome to DÜPERTHAL, Welcome to the Original!

As a leading German quality and technology enterprise, we set the standards when it comes to designing system solutions for process-optimised storage of chemicals and hazardous materials. All of our products and solutions are tailored specifically to meet your requirements. Aside from maximum safety, they offer the highest levels of effectiveness and efficiency – even in situations where there is no risk of fire. We are therefore providing you, as the customer, with reassurance. This is what we, as a family-run company, stand for. The original is what we stand for.



Safeguarding your values –

Since 1973, and into the future

For more than forty years, we have been setting standards in our industry. As our customer, you benefit from our technological and commercial know-how: expertise that has been demonstrated in numerous reference projects for renowned international organisations. We constantly raise the bar, continuing to enhance our safety solutions so that we can help safeguard your values, also in the future.

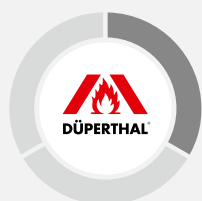

Delivering the perfect system solution –

Customised designs, if needed, TÜV-certified prior to installation.

In addition to standard products of exceptional quality, we are the only company on the market to also offer customised, TÜV-certified system solutions that do not require acceptance on delivery. From consultation to components, installation and routine maintenance – we always strive to offer the best possible added value from the perspective of technical safety and operational management.



Helping you stay one step ahead –

With service and personal communication

By choosing a DÜPERTHAL solution, you are also gaining a strong, proactive partner. Our aim is to always stay one step ahead. All our products and solutions exceed the requirements laid down by certification programmes. The same applies to our work with you. We openly discuss challenges and propose improvements, helping you to always identify the ideal solution.

Our commitment For your safety



Thanks to robust construction and numerous new features, our new UTS ergo line® series offers particularly attractive pieces of laboratory furniture for TRGS 510-compliant storage of hazardous substances in working environments. However, here we do not concentrate solely on the exceptional case of a fire breaking out, but also on your everyday satisfaction when using our safety storage cabinets.

» Outstanding quality	6
» Maximum fire resistance – Type 90	7
» For flexible use	8
» Individual solutions	9
» All-round service	10
» Wide colour range	11
» Protection against unauthorised access	12
» Various optional extras	13
» The UTS ergo line® at a glance	14
» Safety and functionality	16
» UTS ergo line® – Depth 600 mm	18
» UTS ergo line® – Depth 500 mm	26
» Optional extras for added safety	34

Solved internally, confirmed externally and independently

For DÜPERTHAL, quality is the main focus. Proof of this are the quality marks of approval awarded to each of our safety storage cabinets, in recognition of our comprehensive quality management as per DIN EN ISO 9001. One basic condition here is that, apart from our own in-house checks, production of the safety storage cabinets is continuously monitored by external accredited test institutes.



Occupational safety and health

OSHA / EU-OSHA

Protecting employees and the environment is the highest priority when handling hazardous substances. Therefore, DÜPERTHAL UTS ergo line® guarantees compliance with the requirements of OSHA and EU-OSHA.

Tested safety at a very high level including

- » Type testing according to DIN EN 14470-1 by recognised test institutes (TÜV Süd, iBMB Braunschweig, ift Rosenheim).
- » TÜV testing according to DIN EN 14727 (laboratory furniture standard).
- » Type 90 classification in accordance with DIN EN 14470-1.
- » GS/CE mark.



Be prepared for the worst

Utmost care is essential in the handling of hazardous and dangerous substances. Our technologies with superior fire resistance help you in this. In the case of fire, the safety storage cabinets of the UTS ergo line® series are type tested and compliant with DIN EN 14470-1 and guarantee 90 minutes of fire resistance .



Fire resistance of 90 minutes

Fire-proof and explosion-proof safety storage cabinets Type 90 by DÜPERTHAL offer a reliable fire protection of 90 minutes. In case of an emergency, this protection provides enough time to evacuate the building and to extinguish the fire safely and thoroughly.

Functional and safe

Despite all safety provisions, you will never have to do without functionality with the DÜPERTHAL UTS ergo line®. With this range of cabinets, DÜPERTHAL combines laboratory storage with maximum fire resistance, of course type-tested in accordance with DIN EN 14470-1 and the laboratory furniture standard DIN EN 14727. Specially easy-moving and practical wing doors and many additional functions provide the basis for individually optimised and safe work processes.

Maximum safety in all areas

The handling of hazardous substances is subject to stringent regulations – for good reason. DÜPERTHAL can help you to meet all the relevant requirements whilst at the same time optimising your procedures. Our diverse range of products offers you flexible solutions with which to design your laboratory and workspace to your own specifications. Whether you require 90-minute fire resistance, refrigerated media storage or a combined solution for storing flammable hazardous substances with other chemicals, we can help you to create working areas that offer full compliance with all the legal and technical requirements. During the entire process, DÜPERTHAL's qualified professionals are always on hand to provide you with advice.



Safe storage for flammable substances

By guaranteeing 90 minutes of fire-resistant and explosion-proof storage, the Type 90 safety cabinets from DÜPERTHAL comply in all respects with the requirements of the Technical Rules for Hazardous Substances for storing flammable liquids. However, the following is also still applicable: Only those substances may be stored together if their joint storage does not increase the respective risks. Safety storage cabinets and their safety-relevant features thus may not suffer any damage. In response to complex storage requirements, including combined storage, DÜPERTHAL therefore offers solutions such as the hazardous substances centre. We are always glad to assist you with solutions that can optimise your storage facilities. We help you to select suitable safety storage cabinets and optimised accessories, such as exhaust air systems and other extras that facilitate your daily work.

System solutions, tailored to your requirements

DÜPERTHAL offers system solutions for process-optimised storage of chemicals and hazardous substances in scientific research, development and production. Our goal is to accommodate your individual requirements in customised solutions. This is why you can expect not only remarkable certified products, but also outstanding service. Our team will help you to improve your work processes and to integrate our products in the best possible way so as to considerably enhance your safety.



Varied product range

With all our solutions you have a choice between the standard product on the market and highly customised packages with a variety of fitted features. Professional advice and comprehensive service are always guaranteed.

DÜPERTHAL – constant reassurance

For the duration of our partnership, you will benefit from DÜPERTHAL's unique service: from project planning and technical product advice to delivery of the product itself, you can always depend on us.



Always at your service

Specialist carrier with checklist

Safety starts with the delivery of the product. Our specialist carrier works according to a detailed checklist and therefore ensures that our products are professionally installed in their final place of use.

Service agreement – the clever option

With a service agreement, we offer you the full service including maintenance and repair of your safety storage cabinets. Additionally, we will extend the manufacturer's guarantee to cover the contract period of the service agreement. The first inspection within the scope of a service agreement is free of charge.



„Through regular maintenance within the scope of a service agreement, we guarantee the safety of your DÜPERTHAL safety storage cabinets for many years.“

Tommy Fittkau, Manager Technical Service,
Quality Management

Eye-catcher – or inconspicuous storage?

Depending on your working environment, your personal tastes or corporate needs, you can choose between coloured or neutral, pure white cabinets from the UTS ergo line® range. The colour of the base is slate grey (RAL 7015) as a standard. Apart from the colours depicted below, individual colour preferences can also be fulfilled.



Golden yellow
RAL 1004

Light grey
RAL 7035

Zinc yellow
RAL 1018

Pure white
RAL 9010

Locking systems for even more safety

Only authorised personnel should be granted access to the UTS ergo line® safety storage cabinet. After all, the substances stored here will also require skilled handling. Choose the locking system best suited for your facility – for maximum safety when storing dangerous chemicals.



Alternatives for safe access control

Cylinder lock (standard equipment)

All UTS ergo line® cabinets have a cylinder lock, as a standard.

Access with RFID card for intelligent protection against unauthorised access

The UTS ergo line® is perfectly suited for the Modular Protection System MPS, i.e. unlocking of the door with RFID user card with MPS-1.

Integration into locking systems

To integrate the cabinets into existing locking systems, profile half-cylinder locks can be supplied.

Preventing dangers individually

Safety is a complex topic. For this reason, the UTS ergo line® not only offers the tried and tested fire resistance of 90 minutes in the unit for flammable liquids, but also reliable and media-resistant storage space for acids and lye. We have a wide range of accessories to ensure that the safety storage cabinets can be adapted to any local requirements.



Safely stored

Pipe penetrations

We can arrange for variable, reclosable penetrations for stainless steel pipes, cables or hoses up to Ø 28 mm to be incorporated in the cabinet roof or the side panel. Flush-mounted penetrations can also be supplied.

Equipotential bonding

As a standard, the UTS ergo line® is equipped with equipotential bonding saddles at the rear of the cabinet for direct earthing connection in accordance with TRBS 2153.

Floor extraction

Permanent floor extraction guarantees that harmful substances or vapours, which collect at the bottom, are safely picked up and removed with the exhaust air.

Exhaust air systems

Exhaust air systems help prevent explosive areas in working spaces. An integrated exhaust air monitoring unit will emit alarm signals in case of failures (optionally available with ventilator). The exhaust air socket (NW 75) on the cabinet roof facilitates connection to the exhaust air system.

The UTS ergo line® at a glance

As every cabinet has to satisfy different demands, the choice of features is entirely up to you – for instance, the choice of pull-out trays or bottom trays.

UTS ergo S and ST

choice of pull-out tray
or bottom tray

Dimensions [in mm]

Width	Depth	Height
600	593	631



UTS ergo S

UTS ergo ST

Maximum capacity of largest single container [in liter]

10

12

UTS ergo M and MT

choice of pull-out tray
or bottom tray

Dimensions [in mm]

Width	Depth	Height
888	593	631



UTS ergo M

UTS ergo MT

Maximum capacity of largest single container [in liter]

16

19

UTS ergo L, LT and LD

choice of pull-out tray
or bottom tray

Dimensions [in mm]

Width	Depth	Height
1100	593	631



UTS ergo L

UTS ergo LT

UTS ergo LD

Maximum capacity of largest single container [in liter]

21

24

10/10

UTS ergo XL and XLT

choice of pull-out tray
or bottom tray

Dimensions [in mm]

Width	Depth	Height
1400	593	631



UTS ergo XL

UTS ergo XLT

Maximum capacity of largest single container [in liter]

15/10

19/12

UTS ergo S-5 and ST-5

choice of pull-out tray
or bottom tray

Dimensions [in mm]

Width	Depth	Height
600	493	631



UTS ergo S-5

UTS ergo ST-5

**Maximum capacity
of largest single container** [in liter]

8

9

UTS ergo M-5 and MT-5

choice of pull-out tray
or bottom tray

Dimensions [in mm]

Width	Tiefe	Height
888	493	631



UTS ergo M-5

UTS ergo MT-5

**Maximum capacity
of largest single container** [in liter]

12

14

UTS ergo L-5, LT-5 and LD-5

choice of pull-out tray
or bottom tray

Dimensions [in mm]

Width	Depth	Height
1100	493	631



UTS ergo L-5

UTS ergo LT-5

UTS ergo LD-5

Maximum capacity of largest single container [in liter]

16

19

7/7

UTS ergo XL-5 and XLT-5

choice of pull-out tray
or bottom tray

Dimensions [in mm]

Width	Depth	Height
1400	493	631



UTS ergo XL-5

UTS ergo XLT-5

Maximum capacity of largest single container [in liter]

11/7

14/9



The safety storage cabinets of the UTS ergo line® are specially constructed for the storage of hazardous substances close to where they are needed. With the UTS ergo line®, all containers are always safely stored and at your fingertips when you need them.

Focus on functionality



1 Particularly smoothly opening and closing, push-to-open wing doors can be opened by light pressure on the front.



2 The ToeKick base option is the ideal solution for an ergonomic workplace. Users can stand comfortably and use the workbench above the UTS ergo line® cabinet. This relieves the back and avoids constant stubbing of the user's toes.

3 The under-bench cabinets are also optionally available with castors. This facilitates integration in existing laboratory installation concepts.



4 The air supply and exhaust air vents are ideally placed for visual checking. Vapours are extracted by separate ventilation connection sockets. A new and particularly effective airflow system guarantees low energy consumption. This reduces operating costs and nevertheless offers maximum fire protection in accordance with DIN EN 14470-1.

Further features

- 5** Continuous floor extraction takes place through the vented base. This ensures that vapours collecting at the bottom of the cabinet are safely removed and passed to the exhaust air system.
- 6** PP inserts for the bottom tray and the pull-out tray are suitable protection against small quantities of leaking liquids.



One-hand wing door technology

The doors are easy to open and the pull-out tray of the safety storage cabinet is automatically rolled out. In case of fire, a thermocouple automatically closes the Type 90 safety storage cabinet. A logical closure sequence guarantees closing without blocking even when trays are pulled out.





UTS ergo line[®] – Depth 600 mm

The compact safety storage cabinets of the UTS ergo line[®] are the ideal solution for fire resistant storage of flammable liquids close to where they are needed – under the workbench. Configure your own custom storage solution from the various sizes and numerous additional features offered by the range.



UTS ergo ST



UTS ergo S



UTS ergo MT



UTS ergo M



UTS ergo LT



UTS ergo L



UTS ergo LD



UTS ergo XLT



UTS ergo XL

Interior fittings:

- » Bottom trays and pull-out trays made of powder-coated sheet steel, stainless steel available on request.

Construction:

- » Wing doors, powder coated sheet steel.
- » Outer carcass, powder coated sheet steel.
- » Inner carcass made of high-quality decor panels.

Colour:

- » Wing doors available in zinc yellow RAL 1018.
- » Carcass completely in light grey RAL 7035.
- » Individual colours possible.

Ordering information

Tested safety at a very high level including:



1.1.1 UTS ergo line ST – Depth 600 mm



Details

1 bottom tray, 1 perforated sheet insert and classical base 35 mm

Design

Ref. no.

	classical	Push-to-open
Interiour fitting sheet steel	29-060667-001	29-060669-001

Dimensions [in mm]

	Outer	Inner
Width	600	503
Depth	593	463
Height (classical)	631	480
Height (ToeKick)	681	480

Max. storage capacity/standing space

Quantity	Type of container	Size
45	Spray can	400ml
16	Tin	1.0 liter
20	Glass laboratory bottle	1.0 liter
7	Glass laboratory bottle	2.5 liter

Weight [in kg] 106

UTS ergo line® – Depth 600 mm

1.1.2 UTS ergo line S – Depth 600 mm



Details

1 pull-out tray, 1 perforated sheet insert and classical base 35 mm

Design

Ref. no.

	Classical	Push-to-open
Interiour fitting sheet steel	29-060667-003	29-060669-003

Dimensions [in mm]

	Outer	Inner
Width	600	503
Depth	593	463
Height (classical)	631	480
Height (ToeKick)	681	480

Max. storage capacity/standing space

Quantity	Type of container	Size
38	Spray can	400 ml
14	Tin	1.0 liter
17	Glass laboratory bottle	1.0 liter
7	Glass laboratory bottle	2.5 liter

Weight [in kg] 110

1.1.3 UTS ergo line MT – Depth 600 mm



Details

1 bottom tray, 1 perforated sheet insert and classical base 35 mm

Design

Ref. no.

	Classical	Push-to-open
Interiour fitting sheet steel	29-060967-001	29-060969-001

Dimensions [in mm]

	Outer	Inner
Width	888	790
Depth	593	463
Height (classical)	631	480
Height (ToeKick)	681	480

Max. storage capacity/standing space

Quantity	Type of container	Size
74	Spray can	400 ml
26	Tin	1.0 liter
31	Glass laboratory bottle	1.0 liter
13	Glass laboratory bottle	2.5 liter

Weight [in kg] 141

1.1.4 UTS ergo line M – Depth 600mm



Details

1 pull-out tray, 1 perforated sheet insert and classical base 35 mm

Design

Ref. no.

	Classical	Push-to-open
Interiour fitting sheet steel	29-060967-003	29-060969-003

Dimensions [in mm]

	Outer	Inner
Width	888	790
Depth	593	463
Height (classical)	631	480
Height (ToeKick)	681	480

Max. storage capacity/standing space

Quantity	Type of container	Size
61	Spray can	400ml
22	Tin	1.0 liter
25	Glass laboratory bottle	1.0 liter
9	Glass laboratory bottle	2.5 liter

Weight [in kg] 149

1.1.5 UTS ergo line LT – Depth 600mm



Details

1 bottom tray, 1 perforated sheet insert and classical base 35 mm

Design

Ref. no.

	Classical	Push-to-open
Interiour fitting sheet steel	29-061167-001	29-061169-001

Dimensions [in mm]

	Outer	Inner
Width	1100	1003
Depth	593	463
Height (classical)	631	480
Height (ToeKick)	681	480

Max. storage capacity/standing space

Quantity	Type of container	Size
94	Spray can	400ml
33	Tin	1.0 liter
40	Glass laboratory bottle	1.0 liter
18	Glass laboratory bottle	2.5 liter

Weight [in kg] 169

UTS ergo line® – Depth 600 mm

1.1.6 UTS ergo line L – Depth 600 mm



Details

1 pull-out tray, 1 perforated sheet insert and classical base 35 mm

Design

Ref. no.

	Classical	Push-to-open
Interiour fitting sheet steel	29-061167-003	29-061169-003

Dimensions [in mm]

	Outer	Inner
Width	1100	1003
Depth	593	463
Height (classical)	631	480
Height (ToeKick)	681	480

Max. storage capacity/standing space

Quantity	Type of container	Size
82	Spray can	400 ml
29	Tin	1.0 liter
34	Glass laboratory bottle	1.0 liter
15	Glass laboratory bottle	2.5 liter

Weight [in kg] 182

1.1.7 UTS ergo line LD – Depth 600 mm



Details

2 pull-out tray, 2 perforated sheet insert and classical base 35 mm

Design

Ref. no.

	Classical	Push-to-open
Interiour fitting sheet steel	29-061167-005	29-061169-005

Dimensions [in mm]

	Outer	Inner
Width	1100	L: 490/R: 490
Depth	593	463
Height (classical)	631	480
Height (ToeKick)	681	480

Max. storage capacity/standing space

Quantity	Type of container	Size
38/38	Spray can	400 ml
14/14	Tin	1.0 liter
17/17	Glass laboratory bottle	1.0 liter
6/6	Glass laboratory bottle	2.5 liter

Weight [in kg] 187

1.1.8 UTS ergo line XLT – Depth 600 mm



Details

2 bottom trays, 2 perforated sheet insert and classical base 35 mm

Design

Ref. no.

	Classical	Push-to-open
Interiour fitting sheet steel	29-06 1467-001	29-06 1469-001

Dimensions [in mm]

	Outer	Inner
Width	1400	L: 790 / R: 490
Depth	593	463
Height (classical)	631	480
Height (ToeKick)	681	480

Max. storage capacity/standing space

Quantity	Type of container	Size
74/44	Spray can	400ml
26/17	Tin	1.0 liter
31/20	Glass laboratory bottle	1.0 liter
13 / 8	Glass laboratory bottle	2.5 liter

Weight [in kg] 220

1.1.9 UTS ergo line XL – Depth 600 mm

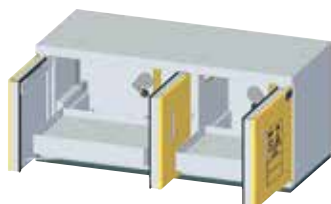

Details

2 bottom trays, 2 perforated sheet inserts and classical base 35 mm

Design

Ref. no.

	Classical	Push-to-open
Interiour fitting sheet steel	29-06 1467-005	29-06 1469-005

Dimensions [in mm]

	Outer	Inner
Width	1400	L: 790 / R: 490
Depth	593	463
Height (classical)	631	480
Height (ToeKick)	681	480

Max. storage capacity/standing space

Quantity	Type of container	Size
56/38	Spray can	400ml
20/14	Tin	1.0 liter
23/17	Glass laboratory bottle	1.0 liter
9 / 6	Glass laboratory bottle	2.5 liter

Weight [in kg] 232

Accessories

Choose from the great variety of accessories the best suited items for your laboratory. Create your own individual work environment tailored to your requirements and work processes.

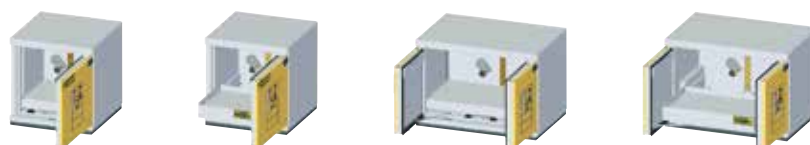

	UTS ergo ST	UTS ergo S	UTS ergo MT	UTS ergo M	
Locking systems:					
Cylinder lock	inclusive	inclusive	inclusive	inclusive	
Lock with profile half cylinder	on request	on request	on request	on request	
MPS-1 with automatic door locking	50-30000-920	50-30000-920	50-30000-920	50-30000-920	
MPS-2 with automatic door closing	50-30000-921	–	50-30000-921	–	
Additional interior fittings: Material:					
Additional pull-out tray	Sheet steel	–	29-10661-119	–	29-10961-119
Insert for bottom tray / bottom tray	PP	29-10660-314	29-10661-314	29-10960-314	29-10961-314
Anti-slip mat	Rubber	29-10660-514	29-10661-514	29-10960-514	29-10961-514
Earthing cable with crocodile clip	1.806.63	1.806.63	1.806.63	1.806.63	1.806.63
Pipe penetration (reclosable)	29-70000-045	29-70000-045	29-70000-045	29-70000-045	29-70000-045
Pipe penetration	29-70000-048	29-70000-048	29-70000-048	29-70000-048	29-70000-048
Fitting options:					
Classical base 85 mm (instead of 35 mm)	29-10660-084	29-10660-084	29-10960-084	29-10960-084	29-10960-084
ToeKick base 85 mm	29-10660-085	29-10660-085	29-10960-085	29-10960-085	29-10960-085
Roller set	29-10900-011	29-10900-011	29-10900-011	29-10900-011	29-10900-011
Industrial ventilation:					
Exhaust air system or ventilator	see page 34 or www.dueperthal.com				
Safety containers					
Absorbers					

For further technical details and dimensions, see page 42.



UTS ergo LT	UTS ergo L	UTS ergo LD	UTS ergo XLT	UTS ergo XL
inclusive	inclusive	inclusive	inclusive	inclusive
on request	on request	on request	on request	on request
50-30000-920	50-30000-920	50-30000-920	50-30000-920	50-30000-920
50-30000-921	–	–	50-30000-921	–
–	29-11161-119	L: 29-11163-119L R: 29-11163-119	–	L: 29-11463-119L R: 29-11163-119
29-11160-314	29-11161-314	L: 29-11163-314L R: 29-11163-314	L: 29-11460-314L R: 29-11460-314	L: 29-11463-314L R: 29-11163-314
29-11160-514	29-11161-514	29-11163-514	L: 29-11460-514L R: 29-11460-514	L: 29-11463-514L R: 29-11163-514
1.806.63	1.806.63	1.806.63	1.806.63	1.806.63
29-70000-045	29-70000-045	29-70000-045	29-70000-045	29-70000-045
29-70000-048	29-70000-048	29-70000-048	29-70000-048	29-70000-048
29-11160-084	29-11160-084	29-11160-084	29-11460-084	29-11460-084
29-11160-085	29-11160-085	29-11160-085	29-11460-085	29-11460-085
29-11400-011	29-11400-011	29-11400-011	29-11400-011	29-11400-011
see page 34 or www.dueperthal.com				



UTS ergo line® – Depth 500 mm

The compact safety storage cabinets of the UTS ergo line® are the ideal solution for fire resistant storage of flammable liquids close to where they are needed – under the workbench. Configure your own custom storage solution from the various sizes and numerous additional features offered by the range.



UTS ergo ST-5



UTS ergo S-5



UTS ergo MT-5



UTS ergo M-5



UTS ergo LT-5



UTS ergo L-5



UTS ergo LD-5



UTS ergo XLT-5



UTS ergo XL-5

Interior fittings:

- » Bottom trays and pull-out trays made of powder-coated sheet steel, stainless steel available on request.

Construction:

- » Wing doors, powder coated sheet steel.
- » Outer carcass, powder coated sheet steel.
- » Inner carcass made of high-quality decor panels.

Colour:

- » Wing doors available in zinc yellow RAL 1018.
- » Carcass completely in light grey RAL 7035.
- » Individual colours possible.

Ordering information

Tested safety at a very high level including:



1.1.10 UTS ergo line ST-5 – Depth 500 mm



Details

1 bottom tray, 1 perforated sheet insert and classical base 35 mm

Design

Ref. no

	Classical	Push-to-open
Interiour fitting sheet steel	29-060657-001	29-060659-001

Dimensions [in mm]

	Outer	Inner
Width	600	503
Depth	493	363
Height (classical)	631	480
Height (ToeKick)	681	480

Max. storage capacity/standing space

Quantity	Type of container	Size
35	Spray can	400 ml
13	Tin	1.0 liter
15	Glass laboratory bottle	1.0 liter
5	Glass laboratory bottle	2.5 liter

Weight [in kg] 99

UTS ergo line® – Depth 500 mm

1.1.11 UTS ergo line S-5 – Depth 500 mm



Details

1 pull-out tray, 1 perforated sheet insert and classical base 35 mm

Design

Ref. no

	Classical	Push-to-open
Interiour fitting sheet steel	29-060657-003	29-060659-003

Dimensions [in mm]

	Outer	Inner
Width	600	503
Depth	493	363
Height (classical)	631	480
Height (ToeKick)	681	480

Max. storage capacity/standing space

Quantity	Type of container	Size
28	Spray can	400 ml
9	Tin	1.0 liter
11	Glass laboratory bottle	1.0 liter
4	Glass laboratory bottle	2.5 liter

Weight [in kg] 101

1.1.12 UTS ergo line MT-5 – Depth 500 mm



Details

1 bottom tray, 1 perforated sheet insert and classical base 35 mm

Design

Ref. no

	Classical	Push-to-open
Interiour fitting sheet steel	29-060957-001	29-060959-001

Dimensions [in mm]

	Outer	Inner
Width	888	790
Depth	493	363
Height (classical)	631	480
Height (ToeKick)	681	480

Max. storage capacity/standing space

Quantity	Type of container	Size
56	Spray can	400 ml
19	Tin	1.0 liter
24	Glass laboratory bottle	1.0 liter
10	Glass laboratory bottle	2.5 liter

Weight [in kg] 134

1.1.13 UTS ergo line M-5 – Depth 500 mm



Details

1 pull-out tray, 1 perforated sheet insert and classical base 35 mm

Design

Ref. no

	Classical	Push-to-open
Interiour fitting sheet steel	29-060957-003	29-060959-003

Dimensions [in mm]

	Outer	Inner
Width	888	790
Depth	493	363
Height (classical)	631	480
Height (ToeKick)	681	480

Max. storage capacity/standing space

Quantity	Type of container	Size
45	Spray can	400ml
16	Tin	1.0 liter
21	Glass laboratory bottle	1.0 liter
7	Glass laboratory bottle	2.5 liter

Weight [in kg] 137

1.1.14 UTS ergo line LT-5 – Depth 500 mm



Details

1 bottom tray, 1 perforated sheet insert and classical base 35 mm

Design

Ref. no

	Classical	Push-to-open
Interiour fitting sheet steel	29-061157-001	29-061159-001

Dimensions [in mm]

	Outer	Inner
Width	1100	1003
Depth	493	363
Height (classical)	631	480
Height (ToeKick)	681	480

Max. storage capacity/standing space

Quantity	Type of container	Size
70	Spray can	400ml
25	Tin	1.0 liter
31	Glass laboratory bottle	1.0 liter
12	Glass laboratory bottle	2.5 liter

Weight [in kg] 161

UTS ergo line® – Depth 500 mm

1.1.15 UTS ergo line L-5 – Depth 500 mm



Details

1 pull-out tray, 1 perforated sheet insert and classical base 35 mm

Design

Ref. no

	Classical	Push-to-open
Interiour fitting sheet steel	29-061157-003	29-061159-003

Dimensions [in mm]

	Outer	Inner
Width	1100	1003
Depth	493	363
Height (classical)	631	480
Height (ToeKick)	681	480

Max. storage capacity/standing space

Quantity	Type of container	Size
61	Spray can	400 ml
22	Tin	1.0 liter
29	Glass laboratory bottle	1.0 liter
10	Glass laboratory bottle	2,5 liter

Weight [in kg] 168

1.1.16 UTS ergo line LD-5 – Depth 500 mm



Details

2 pull-out trays, 2 perforated sheet insert and classical base 35 mm

Design

Ref. no

	Classical	Push-to-open
Interiour fitting sheet steel	29-061157-005	29-061159-005

Dimensions [in mm]

	Outer	Inner
Width	1100	L: 490/R: 490
Depth	493	363
Height (classical)	631	480
Height (ToeKick)	681	480

Max. storage capacity/standing space

Quantity	Type of container	Size
26/26	Spray can	400 ml
9/9	Tin	1.0 liter
11/11	Glass laboratory bottle	1.0 liter
4/4	Glass laboratory bottle	2.5 liter

Weight [in kg] 173

1.1.17 UTS ergo line XLT-5 – Depth 500 mm



Details

2 bottom trays, 2 perforated sheet insert and classical base 35 mm

Design

Ref. no

	Classical	Push-to-open
Interiour fitting sheet steel	29-061457-001	29-061459-001

Dimensions [in mm]

	Outer	Inner
Width	1400	L: 790 / R: 490
Depth	493	363
Height (classical)	631	480
Height (ToeKick)	681	480

Max. storage capacity/standing space

Quantity	Type of container	Size
56/35	Spray can	400ml
19/13	Tin	1.0 liter
24/15	Glass laboratory bottle	1.0 liter
10 / 5	Glass laboratory bottle	2.5 liter

Weight [in kg] 211

1.1.18 UTS ergo line XL-5 – Depth 500 mm

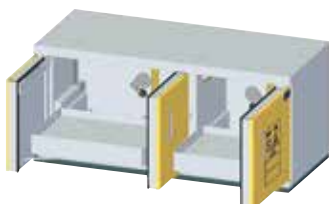

Details

2 pull-out trays, 2 perforated sheet insert and classical base 35 mm

Design

Ref. no

	Classical	Push-to-open
Interiour fitting sheet steel	29-061457-005	29-061459-005

Dimensions [in mm]

	Outer	Inner
Width	1400	L: 790 / R: 490
Depth	493	363
Height (classical)	631	480
Height (ToeKick)	681	480

Max. storage capacity/standing space

Quantity	Type of container	Size
42/26	Spray can	400ml
15 / 9	Tin	1.0 liter
20/11	Glass laboratory bottle	1.0 liter
6 / 4	Glass laboratory bottle	2.5 liter

Weight [in kg] 223

Accessories

Choose from the great variety of accessories the best suited items for your laboratory. Create your own individual work environment tailored to your requirements and work processes.

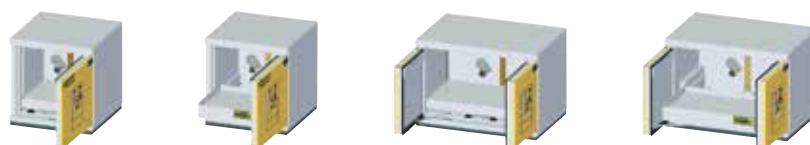

		UTS ergo ST-5	UTS ergo S-5	UTS ergo MT-5	UTS ergo M-5
Locking systems:					
Cylinder lock		inclusive	inclusive	inclusive	inclusive
Lock with profile half cylinder		on request	on request	on request	on request
MPS-1 with automatic door locking		50-30000-920	50-30000-920	50-30000-920	50-30000-920
MPS-2 with automatic door closing		50-30000-921	–	50-30000-921	–
Additional interior fittings:					
Material:					
Additional pull-out tray	Sheet steel	–	29-10651-119	–	29-10951-119
Insert for bottom tray / bottom tray	PP	29-10650-314	29-10651-314	29-10950-314	29-10951-314
Anti-slip mat	Rubber	29-10650-514	29-10651-514	29-10950-514	29-10951-514
Earthing cable with crocodile clip		1.806.63	1.806.63	1.806.63	1.806.63
Pipe penetration (reclosable)		29-70000-045	29-70000-045	29-70000-045	29-70000-045
Pipe penetration		29-70000-048	29-70000-048	29-70000-048	29-70000-048
Fitting options:					
Classical base 85 mm (instead of 35 mm)		29-10650-084	29-10650-084	29-10950-084	29-10950-084
ToeKick base 85 mm		29-10650-085	29-10650-085	29-10950-085	29-10950-085
Roller set		29-10900-011	29-10900-011	29-10900-011	29-10900-011
Industrial ventilation:					
Exhaust air system or ventilator					
Safety containers					
Absorbers					
		see page 34 or www.dueperthal.com			

For further technical details and dimensions, see page 43.



UTS ergo LT-5	UTS ergo L-5	UTS ergo LD-5	UTS ergo XLT-5	UTS ergo XL-5
inclusive	inclusive	inclusive	inclusive	inclusive
on request	on request	on request	on request	on request
50-30000-920	50-30000-920	50-30000-920	50-30000-920	50-30000-920
50-30000-921	–	–	50-30000-921	–
–	29-11151-119	L: 29-11153-119L R: 29-11153-119	–	L: 29-11453-119L R: 29-11153-119
29-11150-314	29-11151-314	L: 29-11153-314L R: 29-11153-314	L: 29-11450-314L R: 29-11450-314	L: 29-11453-314L R: 29-11153-314
29-11150-514	29-11151-514	29-11153-514	L: 29-11450-514L R: 29-11450-514	L: 29-11453-514L R: 29-11153-514
1.806.63	1.806.63	1.806.63	1.806.63	1.806.63
29-70000-045	29-70000-045	29-70000-045	29-70000-045	29-70000-045
29-70000-048	29-70000-048	29-70000-048	29-70000-048	29-70000-048
29-11150-084	29-11150-084	29-11150-084	29-11450-084	29-11450-084
29-11150-085	29-11150-085	29-11150-085	29-11450-085	29-11450-085
29-11400-011	29-11400-011	29-11400-011	29-11400-011	29-11400-011
see page 34 or www.dueperthal.com				

Exhaust air systems and ventilators



To guarantee maximum safety for your employees, connection to exhaust air systems is essential in the case of many chemicals. DÜPERTHAL offers a variety of solutions to stop harmful vapours escaping into the working area. All ventilators and components comply with Directive 94/9/EC (ATEX) and thus meet the highest safety standards.

» Exhaust air systems

» Filter systems

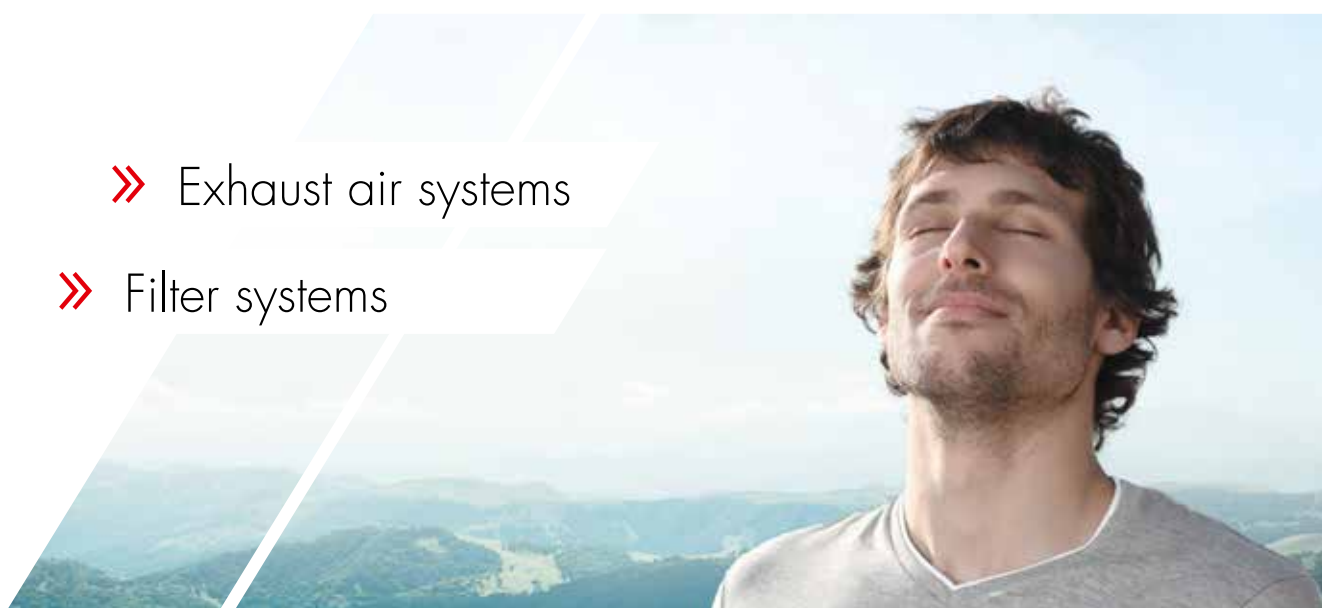

Exhaust air systems



The exhaust air monitor with ventilator is designed for straightforward ventilation and monitoring of safety storage cabinets. A sensor controls the flow of air and emits optical and acoustic alarms if the required value is not reached. The complete exhaust air monitoring unit is pre-assembled on delivery for mounting directly on the cabinet.

Filter systems



Our filter systems are suitable for ventilating and monitoring safety storage cabinets stocked with solvents. They filter almost 100% of any harmful hydrocarbons by means of molecular adsorption, thereby providing users with optimal protection. Additional connection to an exhaust air system is not necessary.

Visit our website for more information on exhaust air systems and other accessories: www.dueperthal.com

More detailed information on the requirements, construction and technical specifications of the ventilation systems we supply for your safety storage cabinets can be found here.



ATEX-compliant
Directive 94/9/EC

Ex II (3) G c IIB T4

Ex II (3) G [n4]



Exhaust air monitor with ventilator

Filter unit with ventilator



**The many advantages of the DÜPERTHAL
exhaust air systems and filter systems**

- » ATEX conformity as per Directive 94/9/EC and type certificate from TÜV Süd.
- » Modern "blue mode" LED display with choice of languages: English, French or German.
- » Pre-assembled on delivery for easy installation.
- » Particularly quiet thanks to high-quality finishing.

Ordering information exhaust air systems

Tested safety at a very high level including:

ATEX  **DIN EN CE**

4.1.1 Exhaust air monitor with ventilator



Details

For easy ventilation and monitoring of safety storage cabinets. A sensor monitors the air stream and gives a visual and audible signal if the value drops below the required value. The complete exhaust air monitoring unit including the integrated ventilator is supplied pre-assembled and is placed directly onto the cabinet. The required value for the air stream flow rate is factory-preset and can be adjusted individually using the pressure difference socket. The housing is made of powder-coated sheet steel, silver pearl glimmer.

- » The exhaust air rate can be adjusted electronically to suit all cabinet sizes.
- » ATEX conformity in accordance with directive 94/9/EC and type certificate by TÜV Süd.
- » An air flow sensor monitors the actual exhaust air flow rate – the complete ventilation system of the cabinet is monitored.
- » Monitoring of the volumetric flow rate and the power supply.
- » Optical and acoustic warning when the exhaust air flow rate falls below the set value.
- » Including two floating contacts (24V/2A) for signal transmission to an external control centre.
- » In case of a power failure, an internal accumulator buffers the monitoring systems for four hours, display with simple fault indication.
- » Model ready to plug in, thus easy to assemble.
- » Memory of the last 50 error messages including date, time, type of error and change of menu.
- » Modern LED-Display "Blue Mode" with language options German, English or French.
- » The exhaust air monitoring function can be switched off.
- » Ventilator according to DIN EN 14986 – low noise level
- » Constant monitoring in accordance with DIN EN 1946-7.

Ref. no.	2.00.320
-----------------	----------

Dimensions [in mm]

Width	250
Depth	318
Height	352

Technical data

Ø collar	mm	75
Volumetric flow rate*	m ³ /h	0 – 72
RPM*	l/min	0 – 2820
Voltage/frequency	V/Hz	230/50
Current consumption	A	0,1
Noise level	db	34 – 56

*gradual, without resistance

4.1.2 Exhaust air monitor without ventilator



Details

For easy monitoring of the ventilation of safety storage cabinets. A sensor monitors the air stream and gives a visual and audible signal if the value drops below the required value. The complete exhaust air monitoring unit is supplied pre-assembled and is placed directly onto the cabinet. The required value for the air stream flow rate is factory-preset and can be adjusted individually using the pressure difference socket. The housing is made of powder-coated sheet steel, silver pearl glimmer.

- » ATEX conformity in accordance with directive 94/9/EC and type certificate by TÜV Süd.
- » An air flow sensor monitors the actual exhaust air flow rate – the complete ventilation system of the cabinet is monitored.
- » Monitoring of the volumetric flow rate and the power supply.
- » Optical and acoustic warning when the exhaust air flow rate falls below the set value.
- » Including two floating contacts (24V/2A) for signal transmission to an external control centre.
- » In case of a power failure, an internal accumulator buffers the monitoring systems for four hours, display with simple fault indication.
- » Model ready to plug in, thus easy to assemble.
- » Memory of the last 50 error messages including date, time, type of error and change of menu.
- » Modern LED-Display "Blue Mode" with language options German, English or French.
- » The exhaust air monitoring function can be switched off.
- » Constant monitoring in accordance with DIN EN 1946-7.

Ref. no.	2.00.360
----------	----------

Dimensions [in mm]

Width	210
Depth	210
Height	215

Technical data

Ø collar	mm	75
Voltage/frequency	V/Hz	230/50
Current consumption	A	0,1

4.1.3 Ventilation unit with ventilator



Details

For easy ventilation of safety storage cabinets. The ventilation unit including the integrated ventilator is supplied pre-assembled and is placed directly onto the cabinet. The housing is made of powder-coated sheet steel, silver pearl glimmer.

- » ATEX conformity in accordance with directive 94/9/EC and type certificate by TÜV Süd.
- » Model ready to plug in, thus easy to assemble.
- » Ventilator according to DIN EN 14986 – low noise level.

Ref. no.	2.00.339	2.00.340
----------	----------	----------

Dimensions [in mm]

Width	250
Depth	318
Height	352

Technical data

Ø collar	mm	75	75
Volumetric flow rate**	m³/h	72	60
RPML**	1/min	2600	1200
Voltage/frequency	V/Hz	230/50	230/50
Current consumption	A	0,1	0,1
Noise level	db	56	37

**without resistance

Ordering information filter systems

4.2.1 Filter unit with ventilator



Details

For ventilation and monitoring of safety cabinets through nearly 100% filtering of harmful vapours of solvents (hydrocarbons) by molecular adsorption. The filtering provides optimal protection of the users. An additional exhaust connection is not required, therefore the filter unit can be positioned directly on top or beside the cabinet and can be started to run. The cleaned air is released to the room, without consuming heated or conditioned air. A sensor monitors the air stream and gives a visual and audible signal if the value drops below the programmed value. The housing is made of powder-coated sheet steel, silver pearl glimmer.

- » The exhaust air rate can be adjusted electronically to suit all cabinet sizes.
- » ATEX conformity in accordance with directive 94/9/EC and type certificate by TÜV Süd.
- » Fulfil the requirements of modern laboratories "green labs" with highest flexibility of installation.
- » **Multistage, earthed filter system with safety of factor 2 – consists of:**
 - 2 x activated carbon filters for extremely high efficiency of the filtration – almost 100%.
 - additional particle filter in accordance with DIN EN 779.
- » **Multistage filter warning system:**
 - Pressure difference monitoring adjustable.
 - Filter elements and cover of filter monitored by microswitches.
 - Time function, up to the next maintenance – in acc. with DIN 12927 and EN 13463.
 - filter change is necessary annually.
 - 3-months-check of the activated carbon filters by the user – monitored through input protocol and time function.
- » List of filterable substances.
- » Warning system with fault indication in case of ventilator failure.
- » Electronic logging of the error messages.
- » Two floating contacts (24V/2A) for signal transmission.
- » Modern LED-Display "Blue Mode" with language options German, English or French.
- » Model ready to plug in, thus easy to assemble.
- » Fulfils the requirements of TRGS 510, DGUV regulation 1 and TRBS 2153.
- » Ventilator according to DIN EN 14986.

Accessories

Activated carbon filter	2.00.391*
Particle filter	2.00.392*
Filter set (activated carbon and particle filter)	2.00.393*

Ref. no.

2.00.390*

Dimensions [in mm]

Width	530
Depth	440
Height	270

Technical data

Ø collar	mm	75
Volumetric flow rate*	m ³ /h	0 – 37
RPM*	1/min	0 – 2820
Voltage/frequency	V/Hz	230/50
Current consumption	A	0,1
Noise level	db	38 – 56

*gradual, without resistance

Tested safety at a very high level including:

ATEX DIN EN CE

4.2.2 Filter unit with ventilator

Details



For ventilation and monitoring of safety cabinets through nearly 100% filtering of harmful vapours of solvents (hydrocarbons) by molecular adsorption. The filtering provides optimal protection of the users. An additional exhaust connection is not required, therefore the filter unit can be positioned directly on top or beside the cabinet and can be started to run. The cleaned air is released to the room, without consuming heated or conditioned air. A sensor monitors the air stream and gives a visual and audible signal if the value drops below the programmed value. The housing is made of powder-coated sheet steel, silver pearl glimmer.

- » Super silent ventilator for especially low noise emission.
- » ATEX conformity in accordance with directive 94/9/EC.
- » Fulfil the requirements of modern laboratories "green labs" with highest flexibility of installation.
- » **Multistage, earthed filter system with safety of factor 2 – consists of:**
 - 2 x activated carbon filters for extremely high efficiency of the filtration – almost 100%.
 - additional particle filter in accordance with DIN EN 779.
- » **Multistage filter warning system:**
 - Filter elements and cover of filter monitored by microswitches.
 - Time function, up to the next maintenance – in acc. with DIN 12927 and EN 13463.
 - filter change is necessary annually.
 - 3-months-check of the activated carbon filters by the user – monitored through input protocol and time function.
- » List of filterable substances.
- » Warning system with fault indication in case of ventilator failure.
- » Floating contact (24V/2A) for signal transmission.
- » LED display for function control.
- » Model ready to plug in, thus easy to assemble.
- » Fulfils the requirements of TRGS 510, DGUV regulation 1 and TRBS 2153.
- » Ventilator according to DIN EN 14986.
- » Constant monitoring in accordance with DIN EN 1946-7.

Accessories

Activated carbon filter	2.00.391*
Particle filter	2.00.392*
Filter set (activated carbon and particle filter)	2.00.393*

Ref. no.

2.00.397*

Dimensions [in mm]

Width	550
Depth	445
Height	275

Technical data

Ø collar	mm	75
Volumetric flow rate*	m ³ /h	24
Voltage/frequency	V/Hz	230/50
Power	W	26
Noise level	db	43

Safety containers for hazardous liquids

Safety containers not only facilitate handling, but also enhance occupational safety when it comes to managing hazardous substances. DÜPERTHAL safety containers comply with various requirements, such as the test standards for occupational safety, the German Equipment and Product Safety Act (GPSG) and the Technical Rules for Hazardous Substances (TRGS). The wide range of containers cover a multitude of uses, ensuring that hazardous liquids can be handled with confidence. They are made of different materials, such as sheet steel, stainless steel or plastic, and offer maximum media resistance. As a guarantee of safety in the public transportation of hazardous substances, the transport vessels have also been tested in accordance with ADR/RID and IMDG, and in some cases ICAO-TI.



A variety of containers for hazardous liquids

Whether the container is intended for distribution, collection or dispensing, DÜPERTHAL safety containers simplify the process of handling hazardous liquids and thus make an important contribution to occupational safety. Whether you work with acids, lye or flammable materials, these containers leave you completely in control.

Visit our website for more information on safety containers and other accessories: www.dueperthal.com

More detailed information on the requirements, construction and technical specifications of our entire range of safety containers can be found here.



Optimised for safe handling

- » Thoroughly resistant to media.
- » Container labelling as per the German Hazardous Substances Ordinance (GefStoffV) and Workplace Directive A1.3 (ASR).
- » All products have been manufactured to the latest technological standards, technical safety requirements and relevant specifications.

Technical Data UTS ergo line® – Depth 600 mm

The possible height for containers to put in is:

- max. 340 mm (pull-out tray with perforated sheet insert)
- max. 404 mm (interior fittings: pull-out tray)
- max. 386 mm (interior fittings: bottom tray with perforated sheet insert)
- max. 450 mm (interior fittings: bottom tray)

Dimensions – interior fittings [in mm]							Model sizes											
	ST			S			MT			M			LT			L		
	Width	Depth	Height	Width	Depth	Height	Width	Depth	Height	Width	Depth	Height	Width	Depth	Height	Width	Depth	Height
Pull-out tray	–	–	–	427	432	101	–	–	–	677	432	101	–	–	–	892	432	101
Bottom tray	494	438	64	–	–	–	781	438	64	–	–	–	994	438	64	–	–	–
Perforated sheet insert	476	420	64	–	–	–	763	420	64	–	–	–	976	420	64	–	–	–
Perforated sheet insert/pull-out tray	–	–	–	413	414	64	–	–	–	659	414	64	–	–	–	847	414	64

Dimensions – interior fittings [in mm]				Model sizes																	
	LD			left			XLT			right			left			XL			right		
	Width	Depth	Height	Width	Depth	Height	Width	Depth	Height	Width	Depth	Height	Width	Depth	Height	Width	Depth	Height			
Pull-out tray	416	432	101	–	–	–	–	–	–	631	432	101	–	–	–	416	432	101			
Bottom tray	–	–	–	781	438	64	485	438	64	–	–	–	–	–	–	–	–	–			
Perforated sheet insert	–	–	–	763	420	64	467	420	64	–	–	–	–	–	–	–	–	–			
Perforated sheet insert/pull-out tray	398	414	64	–	–	–	–	–	–	613	414	64	398	414	64	–	–	–			

Technical Data				Model sizes														
				ST	S	MT	M	LT	L	LD		XLT		XL				
										left	right	left	right	left	right			
Load bearing capacity with uniformly distributed load (maximum loadability/shelf)	in kg	Bottom tray	60	–	60	–	60	–	–	–		60	60	–				
		Pull-out tray	–	45	–	45	–	45	45	45	–		45	45				
Maximum volume of the largest individual container that may be stored in the cabinet	in l	–	12	10	19	16	24	21	10	10	19	12	15	10				
Collection volume	in l	Bottom tray	13,2	–	21,3	–	27,2	–	–	–	21,3	13,2	–	–				
		Pull-out tray	–	11,3	–	18,1	–	23,9	11	–	–	16,8	11					
Base height (other base heights available on request)	in mm	with classical base	35	35	35	35	35	35	35	35	35	35	35	35				
		with ToeKick base	85	85	85	85	85	85	85	85	85	85	85					
Volumetric flow rate for 10-fold air exchange	in m³/h	–	1.1	1.1	1.7	1.7	2.2	2.2	2.2	2.2	2.7	2.7	2.7					
Pressure drop in the cabinet	in Pa.	–	<1	<1	<1	<1	<1	<1	<1	<1	<1	<1	<1					

The possible containers height with additional pull-out tray:

max. 190 mm (from pull-out tray with perforated sheet insert up to bottom edge of additional pull-out tray)
 max. 200 mm (from pull-out tray without perforated sheet insert up to bottom edge of additional pull-out tray)
 max. 190 mm (from additional pull-out tray up to inside top of cabinet)

Dimensions – interior fittings [in mm]							Model sizes											
	ST-5			S-5			MT-5			M-5			LT-5			L-5		
	Width	Depth	Height	Width	Depth	Height	Width	Depth	Height	Width	Depth	Height	Width	Depth	Height	Width	Depth	Height
Pull-out tray	–	–	–	427	332	101	–	–	–	677	332	101	–	–	–	892	332	101
Bottom tray	494	338	64	–	–	–	781	338	64	–	–	–	994	338	64	–	–	–
Perforated sheet insert	476	320	64	–	–	–	763	320	64	–	–	–	976	320	64	–	–	–
Perforated sheet insert/pull-out tray	–	–	–	413	314	64	–	–	–	659	314	64	–	–	–	847	314	64

Dimensions – interior fittings [in mm]				Model sizes																	
	LD-5			links			XLT-5			rechts			links			XL-5			rechts		
	Width	Depth	Height	Width	Depth	Height	Width	Depth	Height	Width	Depth	Height	Width	Depth	Height	Width	Depth	Height			
Pull-out tray	416	332	101	–	–	–	–	–	–	–	–	–	631	332	101	416	332	101			
Bottom tray	–	–	–	781	338	64	485	338	64	–	–	–	–	–	–	–	–	–			
Perforated sheet insert	–	–	–	763	320	64	467	320	64	–	–	–	–	–	–	–	–	–			
Perforated sheet insert/pull-out tray	398	314	64	–	–	–	–	–	–	613	314	64	398	314	64	–	–	–			

Technical Data			Model sizes											
			ST-5	S-5	MT-5	M-5	LT-5	L-5	LD-5		XLT-5		XL-5	
									left	right	left	right	left	right
Load bearing capacity with uniformly distributed load (maximum loadability/shelf)	in kg	Bottom tray	60	–	60	–	60	–	–		60	60	–	
		Pull-out tray	–	40	–	40	–	40	40	40	40	–	40	40
Maximum volume of the largest individual container that may be stored in the cabinet	in l	–	9	8	14	12	19	16	7	7	19	9	11	7
Collection volume	in l	Bottom tray	10,4	–	16,4	–	20,9	–	–	–	16,4	10,2	–	–
		Pull-out tray	–	8,9	–	13,9	–	18,3	8,4		–	–	12,9	8,4
Base height (other base heights available on request)	in mm	with classical base	35	35	35	35	35	35	35		35		35	
		with ToeKick base	85	85	85	85	85	85	85		85		85	
Volumetric flow rate for 10-fold air exchange	in m³/h	–	0.9	0.9	1.4	1.4	1.7	1.7	1.7		2.2		2,2	
Pressure drop in the cabinet	in Pa.	–	<1	<1	<1	<1	<1	<1	<1		<1		<1	

Technical Data UTS ergo line® – Depth 600 mm

Side view

Top view

Rear view

UTS ergo ST

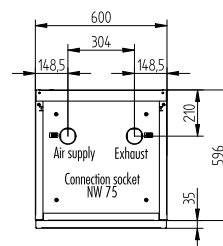
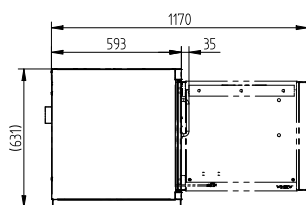

UTS ergo S

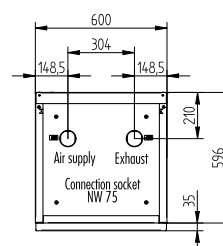
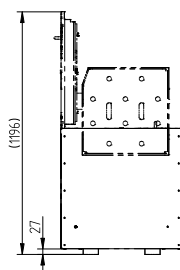
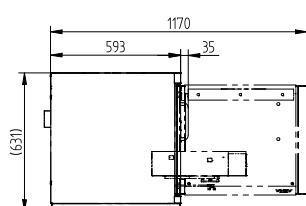

UTS ergo MT

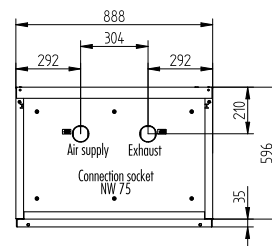
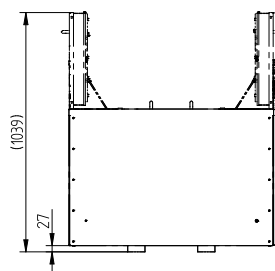
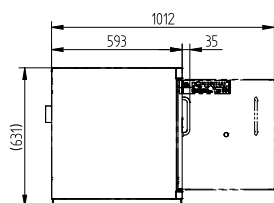

UTS ergo M

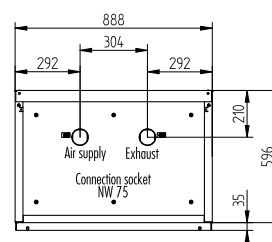
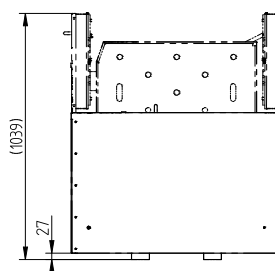
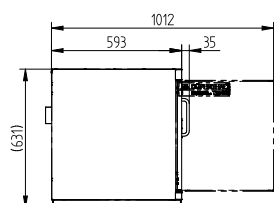

UTS ergo LT

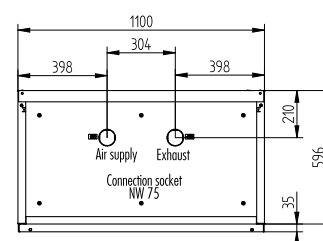
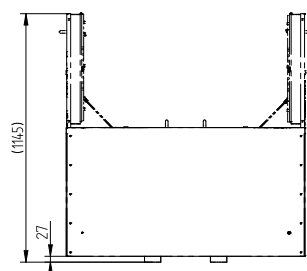
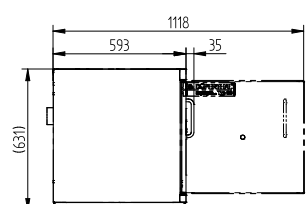

Side view

Top view

Rear view

UTS ergo L

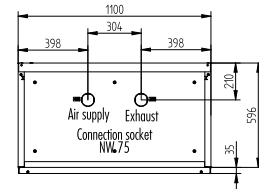
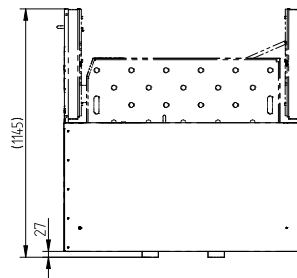
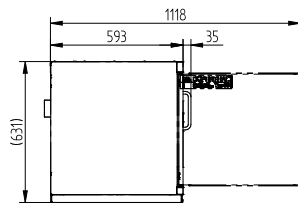

UTS ergo LD

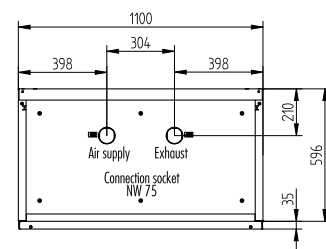
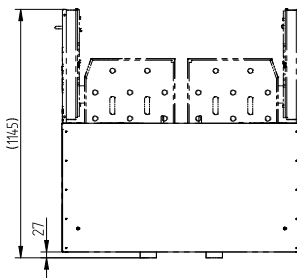
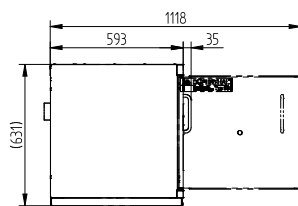

UTS ergo XLT

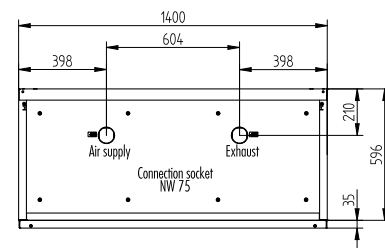
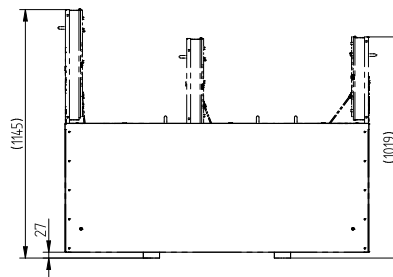
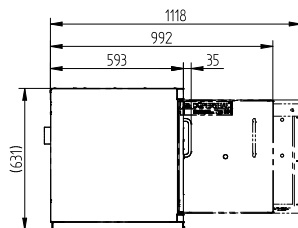

UTS ergo XL

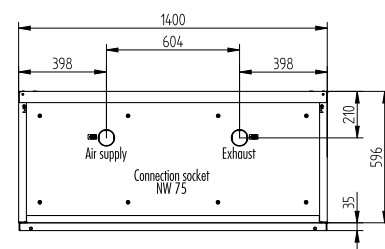
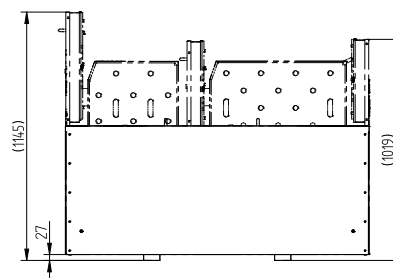
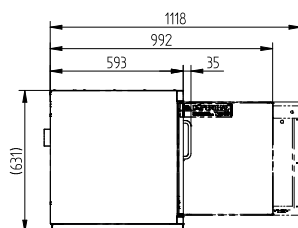

Technical Data UTS ergo line® – Depth 500 mm

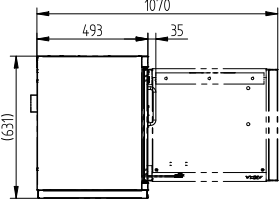
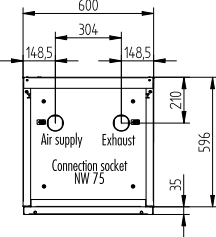
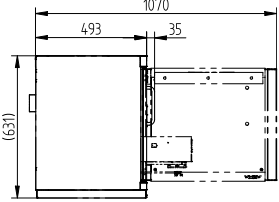
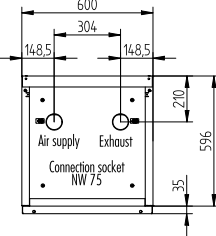
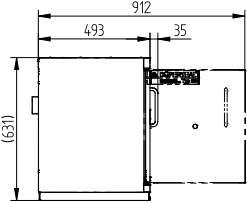
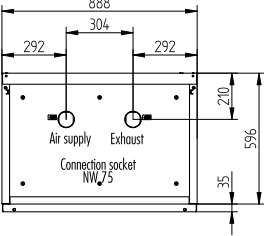
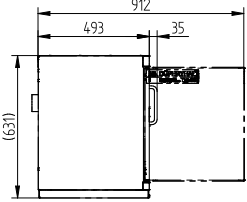
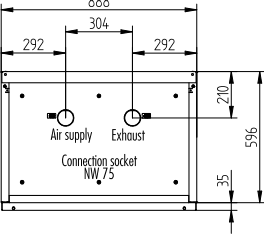
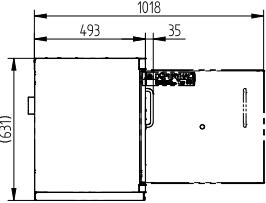
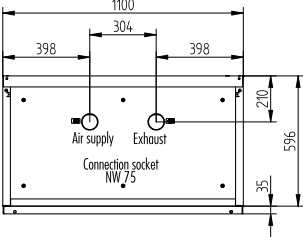
Side view	Top view	Rear view
UTS ergo ST-5		
UTS ergo S-5		
UTS ergo MT-5		
UTS ergo M-5		
UTS ergo LT-5		

Side view

Top view

Rear view

UTS ergo L-5

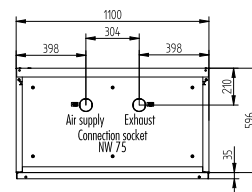
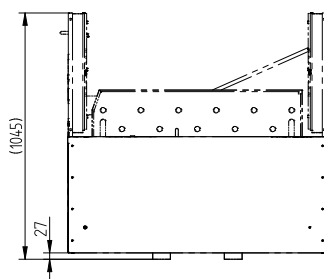
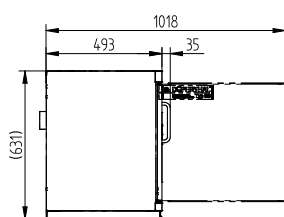

UTS ergo LD-5

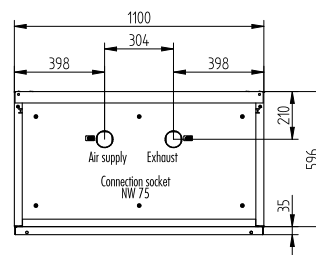
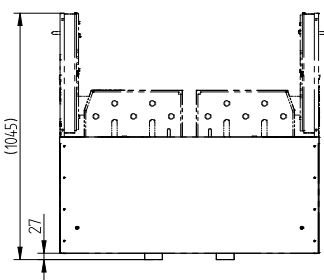
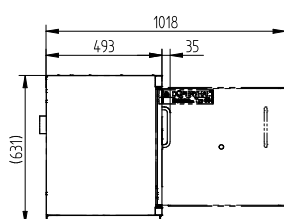

UTS ergo XLT-5

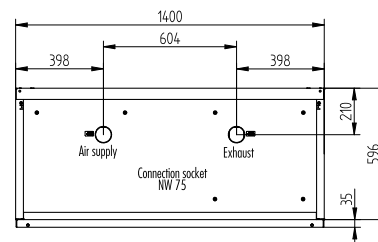
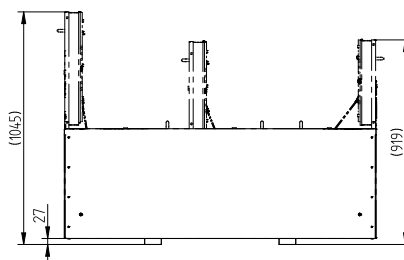
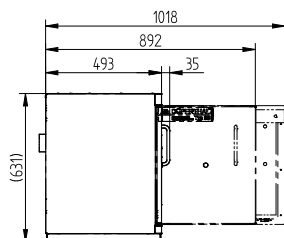

UTS ergo XL-5

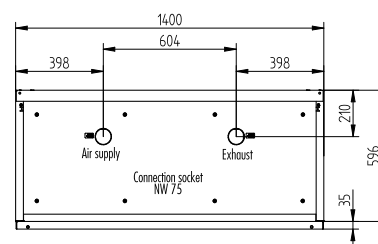
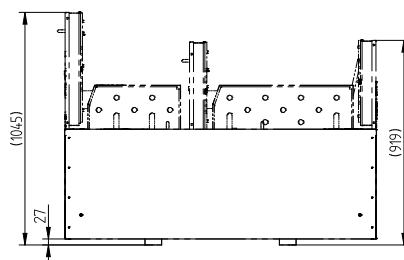
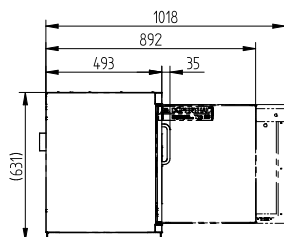



For more information on other DÜPERTHAL products contact STEQ America, DÜPERTHAL's supplier in North America.
(267) 245-7010 | www.steqamerica.com | info@steqamerica.com

DÜPERTHAL Sicherheitstechnik GmbH & Co. KG

Frankenstrasse 3 | 63791 Karlstein | Germany

Phone +49 6188 9139-0 | Fax +49 6188 9139-121

info@dueperthal.com | www.dueperthal.com

© 2015 DÜPERTHAL Sicherheitstechnik GmbH & Co. KG | sh | active_10.12 | Rev04_EN

All rights reserved. No part of this document may be reproduced. Civil action will be taken against infringements. We reserve the right to increase prices and make technical changes through improvements and further development and to update the document accordingly in response to standardisation. We do not accept any liability whatsoever for printing errors. Slight colour differences in the illustrated products are possible due to printing.